

Hyland Manor Apartments

751 Clarke Road, Coquitlam, BC

BALCONY
10'7" x 5'0"

LIVING
7'1" x 12'0"

BATH
5'2" x 6'11"

WIC
5'2" x 3'5"

BEDROOM
7'3" x 12'7"

FOYER
4'11" x 10'10"

DINING
9'9" x 6'1"

KITCHEN
8'7" x 7'7"

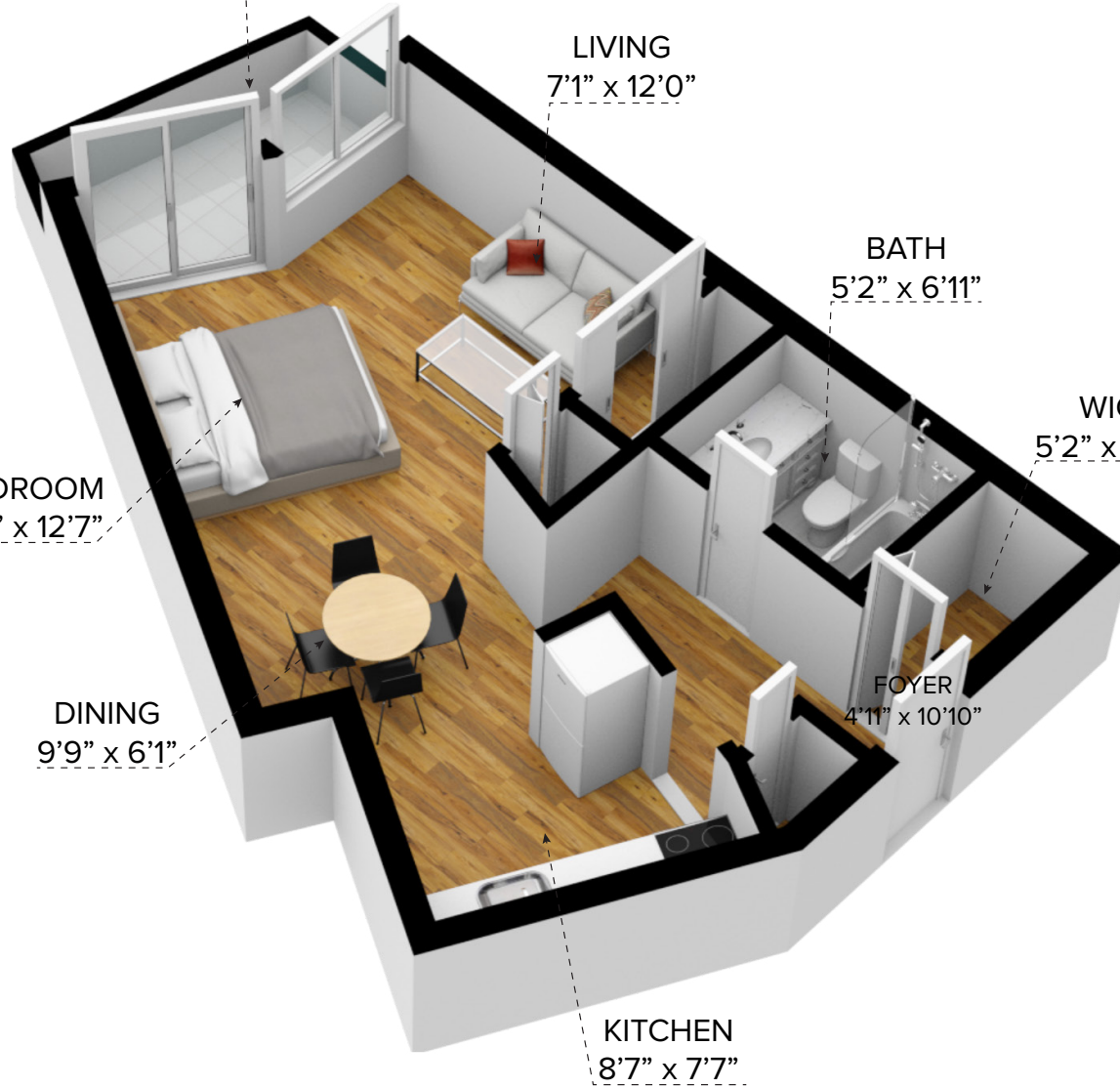

CANADIAN APARTMENT
PROPERTIES • REIT

10751-BA - Bachelor (565 sq.ft.)